

CLAYMORE³ heady II

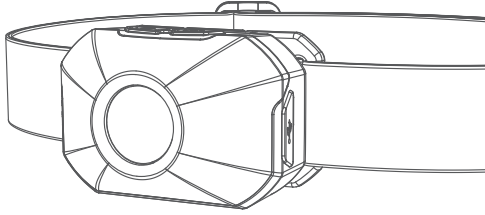

User Manual

CLAYMORE heady II CLC-420

This portable light contains Li-Polymer batteries. Please follow the user manual before use. If any abnormality is found in the product, discontinue use and contact the dealer or a service center where the product was purchased. Any modifications of this product will void the warranty. Misuse of CLAYMORE products may cause user harm.

Caution

- ① Do not use near high temperatures such as fires or heating equipments. It may cause explosion and ignition.
- ② This product is water resistant. However, if left in the rain for a long time, it may cause malfunction. If the product gets soaked, please quickly wipe it off.
- ③ Do not store or use in vehicles exposed to direct sunlight. It may cause explosion and malfunction.
- ④ Do not touch the light source directly as it may become very hot during use.
- ⑤ Do not use if the product exceeds the operating temperature range (-10°C to 40°C).
- ⑥ Do not look directly into the LED light source.
- ⑦ Please do not place in the reach of infants. It may cause swallowing of parts or injury.
- ⑧ Adult supervision is necessary when used by children. Misuse of head lamp may cause injury or electric shock.
- ⑨ Do not insert any metal parts into the terminal block of the connector. It may cause heat, explosion or electric shock.
- ⑩ Do not disassemble or modify the product.
- ⑪ Do not touch the connector with wet hands. There is a danger of electric shock.
- ⑫ After use, be sure to turn off the power. If not, it may cause leakage.
- ⑬ When adjusting the angle, please do not bend with force. It may cause damage to the product.
- ⑭ Dropping or impacting the product can cause damage to the inside of the product, resulting in unexpected failures in normal use. Be careful not to apply impact to the body.

Components

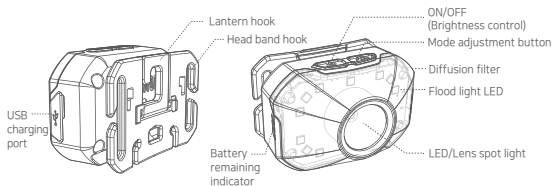

Operation

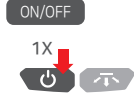

Light turns on when pushing the power button shortly. Repeat to turn off the light.

Stepless Dimming



When light is on, Press and hold the mode adjustment button to adjust brightness to increase brightness. Press and hold the power button once again to decrease brightness.

5 STEP Dimming



If light is activated, push down the power button and press the mode adjustment button to control 5 step dimming.

※ Blinks once when Maximum and Minimum brightness is reached.

CCT Change



When light is on, push the mode adjustment button over 2 seconds to change ※ 3 different light modes



MODE1 Focused Light(8°) Spot | For hiking



MODE2 Diffused Light(Cool White) Flood | For camping



Warm LED light with low color temperature, warm light feels like ordinary gas lantern
Cool LED light with high color temperature, cool light feels like ordinary fluorescent light

SOS-flash



When light is on, push the mode adjustment button over 2 seconds to make SOS signal on each mode.

Charging method

Open rubber cover and connect USB cable to charge.

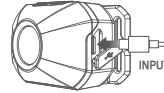

※ This lantern contains memory function that returns to the last setting it was set at.

Specification

	Focused Light (8°)		Flood Light (Cool)		Flood Light (Warm)	
	MIN	MAX	MIN	MAX	MIN	MAX
Brightness	10Lm	350Lm	10Lm	350Lm	5Lm	175Lm
Operating time	40hour	3.5hour	40hour	3.5hour	40hour	7hour
Distance	3M	80M				

Product name	CLAYMORE heady II	Size	59.8x40x39.7mm
Model name	CLC-420	Weight	58g
Battery capacity	Li-Polymer 3.7V 1,200mAh(4.44Wh)	Charging time	2hour
Input	USB 5V 1A	Origin	MADE IN KOREA
Color temperature	Warm : 3000K, Cool : 6200K (±15%)		

Contents



⚠ Caution for long-term storage

- * If the battery is completely drained, the battery indicator might not flash. If this happens, plug the USB cable back in or press the button to turn the battery indicator on again.
- * For long-term storage, fully recharge the battery. (Repeat every six months)
- * Please keep in mind that if stored below -10°C the battery life may be affected.
- * Please keep in a dry place without moisture.

Battery check

When charging, battery indicator will flicker in 3 steps to display remaining battery. (Battery remaining will be shown for 2 seconds in 1 step brightness during each mode)

Battery indicator

	0~33%	Flickers
	33~66%	
	66~99%	
	Fully charged	Stop

Instructions

● Headband

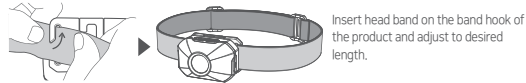

● Using Clip

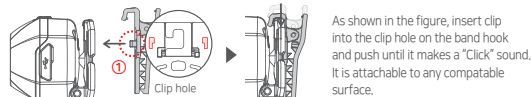

● Angle adjustment

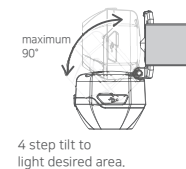

4 step tilt to light desired area.

● Lantern Hook

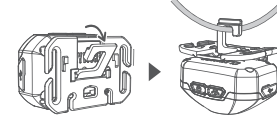

Mountable on Carabiner or hangable on a line with hook.

Warranty

Item	CLAYMORE heady II
Model No.	CLC-420
Seller	
Date of Purchase	

1. Thank you for purchasing CLAYMORE series of Prism Co., Ltd.
2. This product has passed strict quality control tests. If the product is not functioning properly, please contact an authorized service center listed below.

Free Service

- 1) Failure of the product under normal operating conditions during the warranty period will be repaired by Prism or authorized service center on free of charge. Some shipping or handling charges may be involved.
- 2) Warranty period: 1 year.

Charged Service

- 1) Damage caused when the warranty period is over.
- 2) Damage caused due to the user's mishandling, abuse, or improper operation.
- 3) Damage caused by arbitrary or personal repair or disassembly in unauthorized service center.
- 4) Damage from input electricity or cable defect.
- 5) Damage caused by natural disaster.

CLAYMORE³

Prism Co., Ltd.

221, Pyeongcheon-ro, Bupyeong-gu, Incheon, Republic of Korea
www.claymorelight.com · www.prismlight.co.kr · info@prismlight.co.kr